



MORALT
the core of the door

FERRO

KlassikPlus



5-ply
faces



Exterior grade
MDF faces



Flat steel
stabilizer



PU hard
foam core



Laminated
core



Robust
construction



Made in Germany

www.moralt-ag.de



FERRO KlassikPlus

FERRO KlassikPlus Akustik



Cross-section lock-side

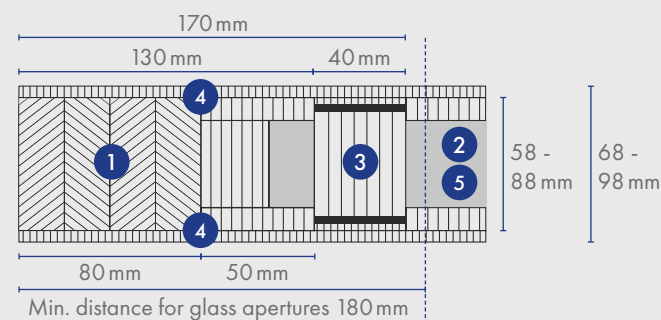

Cross-section hinge-side

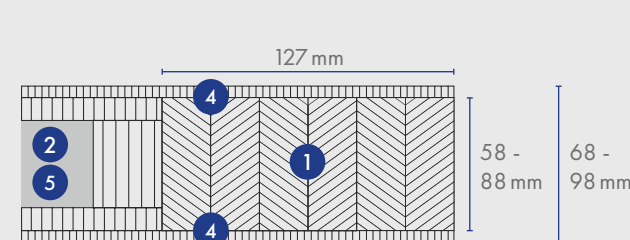

- 1 Framing / stiles & rails
2 Sandwich system with PU hard foam
3 Flat steel stabilizer
4 Facing
5 Sandwich system with PU hard foam and sound insulation insert

Technical details

FRAME

1 Timber framing	Timber framing finger-jointed and laminated.		
Frieze, trim, glass aperture	Thickness of door blank 68/78/88/98 mm		
	Frame width in mm		Can be trimmed by
	Top	127	75*
	Side	lock-side 80/hinge-side 127	lock-side 25*/hinge s. 75*
	Bottom	127	85*
	Minimum distance for glass apertures is 180 mm on all four sides. The frame width corresponds to the shortening dimension. When trimmed by a maximum at the bottom (85 mm) a single rebate (max. 18 mm) or fitting of drop down seal is possible.		

INNER LAYER

2 Construction	<ul style="list-style-type: none">Sandwich construction of laminated core and HCFC-free and environmentally compatible PU hard foamSurface stability through vertically aligned annual rings
Bonding	Free of formaldehyde
3 Flat steel stabilizer	Lock-side flat steel stabilizer – thermally separated and sound insulated – to absorb traction and shearing forces. Stabilizers are glued and friction-locked with the framework.

4 FACING

Bonding	Veneer plywood AW bonding according to DIN 68705-2, 5 layers (noble veneer), 3 layer (cross veneer) = individually veneerable, MDF/HDF exterior = paintable or veneerable, full-surface bonding with the overall construction, min. stress group D4 according to DIN EN 204/205 and DIN EN 14257 (WATT 91)
---------	--

EXTERNAL DOOR BLANK

Model/finish	Trimmed edges and sanded surfaces
--------------	-----------------------------------

* with a max. rebate of 30 mm

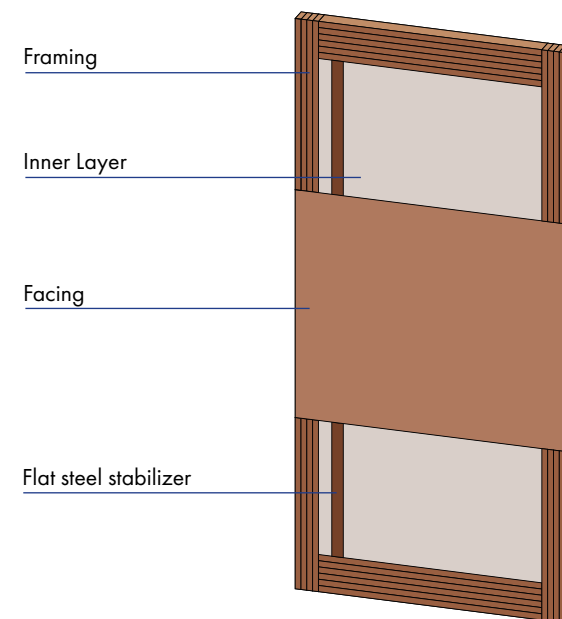

Product Range

Thickness in mm	68 / 78 / 88 / 98	
Thickness in mm cross-veneered RV	66 / 76 / 86 / 96	
Length in mm	default	can be cut to
	2,110	1,950
	2,240	2,080
	2,370	2,210
	2,470	2,310
	2,600	2,440
Maximum length of 2,980 mm available on request.		
Width in mm	default	can be cut to
	950	850
	1,050	950
	1,150	1,050
	1,230	1,130
	1,250**	1,150

Face types

Veneer plywood: Mahogany SV, Okumé/Gabun SV, Meranti FL, Oak*, knotty Oak*, knotty Oak 3.5mm*, rustic knotty Oak cross-veneered, Pine FL/ SV, Spruce FL/SV, Larch*, knotty Larch*, white Fir, paint-grade SV.

Or: MDF/HDF-exterior**, HPL/CPL laminate

Framing / stiles & rails

Oak, Larch, Conifer wood, Redwood

*cross-grain also available **Only MDF-Exterior possible up to a width of 1,250 mm SV=sliced veneer FL=Fineline RV=rotary cut veneer Further dimensions, sizes and facings on request.

Certification

Height in mm	up to 2,600		Maximum door leaf size: 3.2m ²	
Width in mm	up to 1,250			
Thickness in mm	68	78	88	98
Different climate testing DIN EN 1121 : 2000-09	test climate c, d, e			
Tolerance classes (by using three hinges) DIN EN 12219 : 2000- 6	3			
Thermal transfer coefficient U-value (W/m²K) DIN EN ISO 10077-2:2012-06	0.95	0.84	0.73	0.65
Acoustic performance DIN EN ISO 717-1 R _{wp} (dB)	30 / 38			
Burglar resistance DIN EN 1627 : 2011-09	RC2 / RC3*			
Weight 2,240 x 1,050 mm kg/piece	62	70	72	78

* tested & valid to H 2,470 mm

CNC-processing service

All types may be delivered CNC processed.



Any questions?

Info-Hotline: 08026 92538-11

Moralt AG

Obere Tiefenbachstraße 1
83734 Hausham

Phone: +49 8026 92538-0
Telefax: +49 8026 92538-40
Mail: sales@moralt-ag.de

